



Long Lane, London, N2 8JX

Offering a spacious one bedroom duplex maisonette, with its own garden. Freshly decorated and new carpets, this south facing apartment offers an open plan living/kitchen room, which leads into a conservatory for extra living space, then out to its own section of garden. The garden is mainly laid to lawn and has a large garden shed to house your garden furniture. This flat has an added bonus of off street parking on a first come first served basis. Council tax Band C, EPC - D , Deposit £2075 Available Mid April.

£1,800 Per Month

Ground Floor

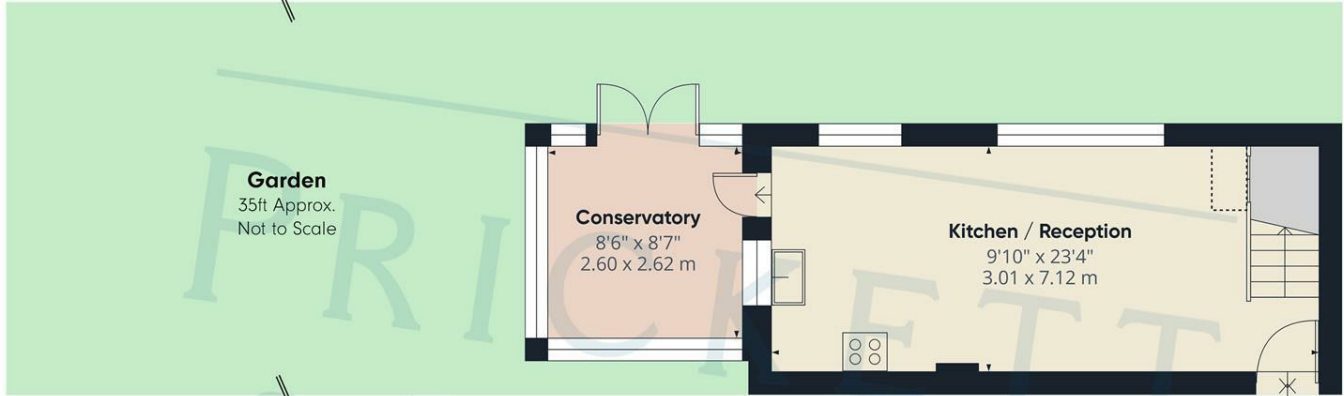

First Floor

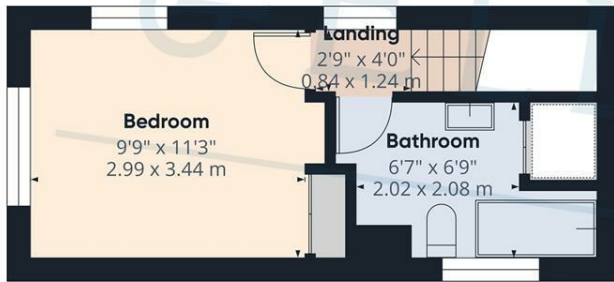

Approximate Total Area (Not Including Garage):

547.8 ft²
50.89 m²

While every attempt has been made to ensure accuracy, all measurements are approximate, not to scale. This floor plan is for illustrative purposes only.



Energy Efficiency Rating		Current	Potential
Very energy efficient - lower running costs			
(92 plus) A			
(81-91) B			
(69-80) C			
(55-68) D			
(39-54) E			
(21-38) F			
(1-20) G			
Not energy efficient - higher running costs			
		60	76
England & Wales	EU Directive 2002/91/EC		

Environmental Impact (CO ₂) Rating		Current	Potential
Very environmentally friendly - lower CO ₂ emissions			
(92 plus) A			
(81-91) B			
(69-80) C			
(55-68) D			
(39-54) E			
(21-38) F			
(1-20) G			
Not environmentally friendly - higher CO ₂ emissions			
England & Wales	EU Directive 2002/91/EC		